

Frank Vazquez Ruffed Grouse and Woodcock Management Area

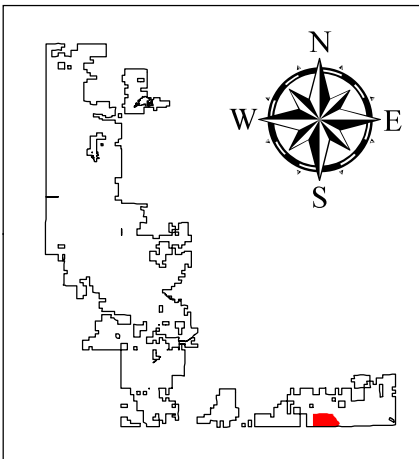
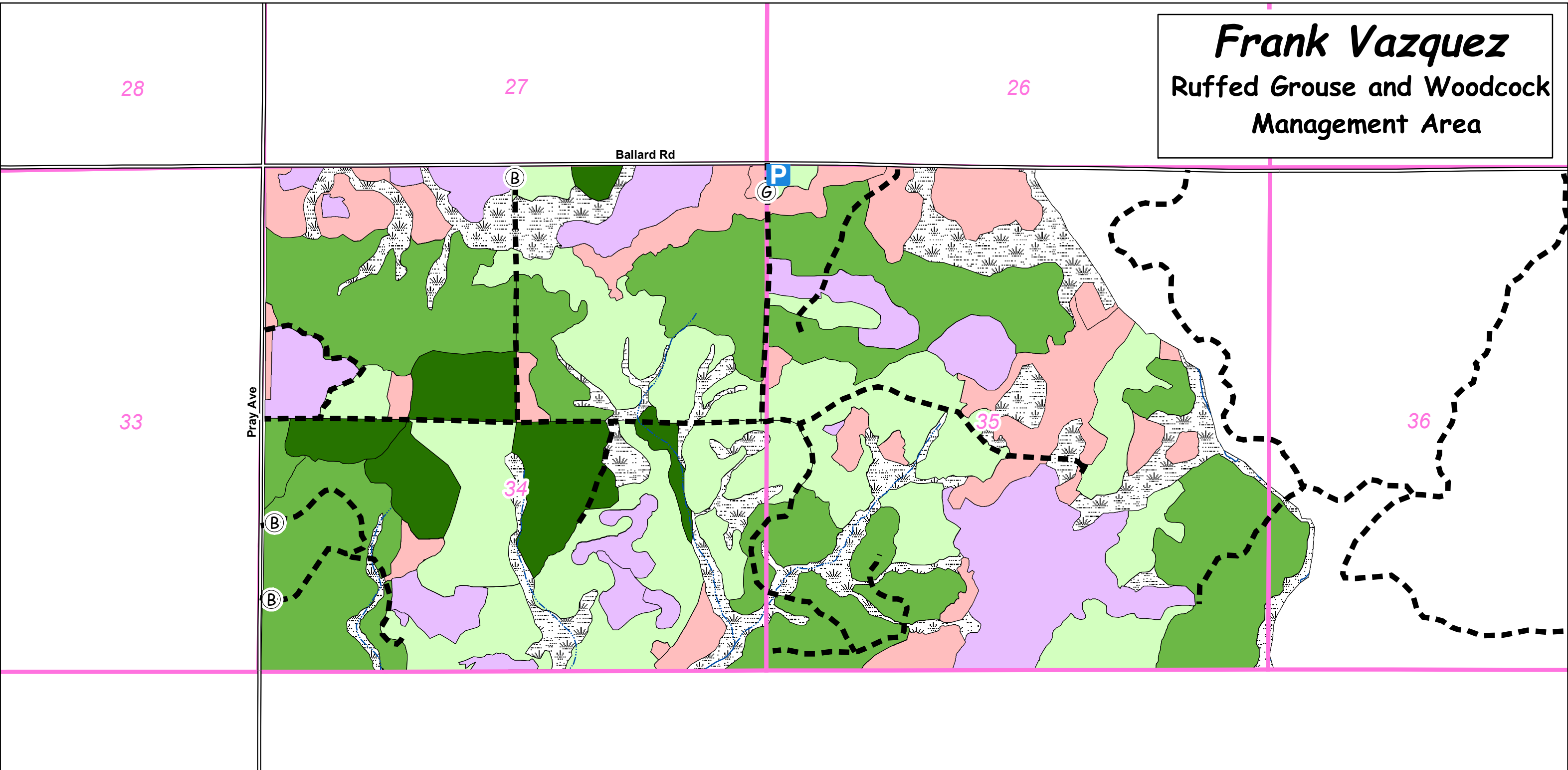

Sections 34, 35, 36
Washburn Township (T23N R1W)
Clark County, Wisconsin

| | | |
|---------------------------------|---------------------------|-------------------------------|
| Covertypes | Section Lines | P Vazquez Parking Area |
| Aspen 31+ years (80 acres) | ----- Woods Roads * | B Earthen Bunker |
| Aspen 16 - 30 years (364 acres) | ----- Intermittent Stream | G Gate |
| Aspen 0 - 15 years (296 acres) | ----- Perennial Stream | |
| Wetland/Alder (150 acres) | | |
| Conifer (157 acres) | | |
| Hardwood (155 acres) | | |

* 6 miles within management area.

Map Created April 20, 2017

